

# DD136H Receiver Specification

VersionNO.:A/01

## T Type specification

Technical support



DD136H receiver

- DD136H is black
- Wireless reception
- Electronic, light touch
- Dial switch direction function
- Working temperature: -10°C ~ +65°C
- Maximum output power: 500W
- One DC1686M receiver maximum can store 10 channels, over 10 channels, if still need add new channels, it will be repeating covered last channel.

! When in the group control mode, the setting up is unworkable.

## T Control range

Technical support

! Launch effective distance will be due to a deviation of the actual environment.

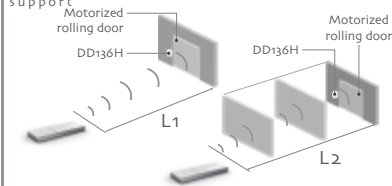

	L1 open	L2 partition	Reception frequency
230V/50Hz	200m	40m	433.05~434.79MHz

## T Matchable emitter

Technical support

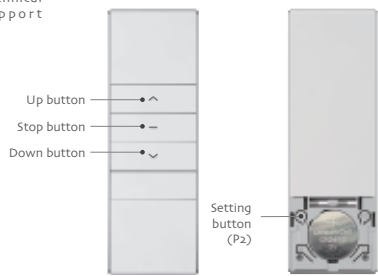

DD1600H single-channel emitter

DD1600H Back

## T Button description

Technical support

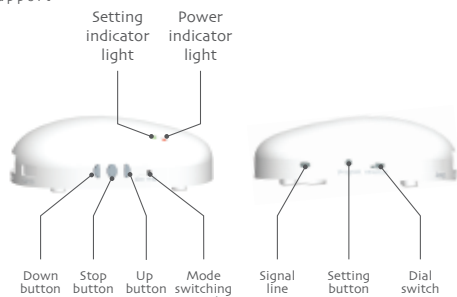

## T Mode of connection

Technical support

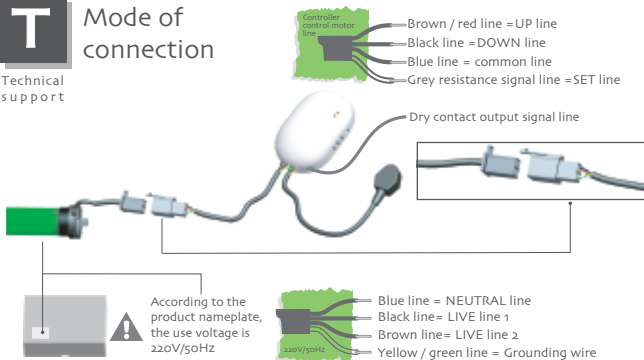

According to the product nameplate, the use voltage is 220V/50Hz

- Blue line = NEUTRAL line
- Black line = LIVE line 1
- Brown line = LIVE line 2
- Yellow / green line = Grounding wire

## T The best installation distance

Technical support

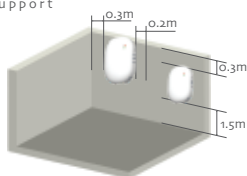

- The shortest distance between receiver and ground ≥1.5m
- The shortest distance between receiver and roof ≥0.3m
- The shortest distance between receiver and receiver ≥0.2m

## A Setting up and add emitter

Additional function

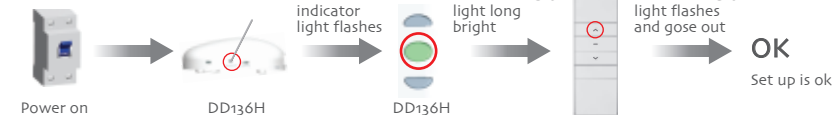

! During the settings, the time between two operation must be shorter than 10s, otherwise it will quit the setting.  
 ① receivers can store up to 10 emitter channels at most.  
 ② emitters can control up to 10 receivers at most.

## A Delete one emitter

Additional function

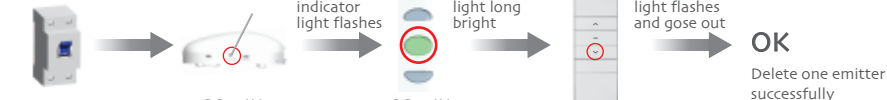

! During the settings, the time between two operation must be shorter than 10s, otherwise it will quit the setting.

## A Delete all emitters

Additional function

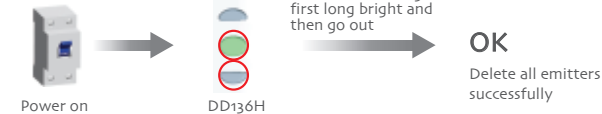

## A Jog-move function

Additional function

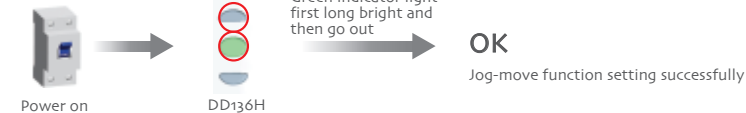

! Repeat setting, function is cancelled;

## A Dial switch direction setting

Additional function

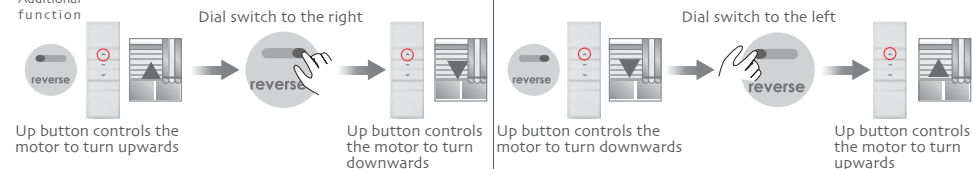

! This operation must be operated when the motor is stopped.

## A Mode switching setting

Additional function

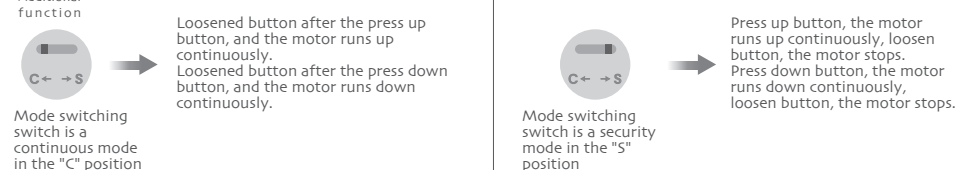

Mode switching switch is a continuous mode in the "C" position

Mode switching switch is a security mode in the "S" position