

DD1610H

Single-channel Emitter

Instruction

Version: A/05

Instruction Of Buttons

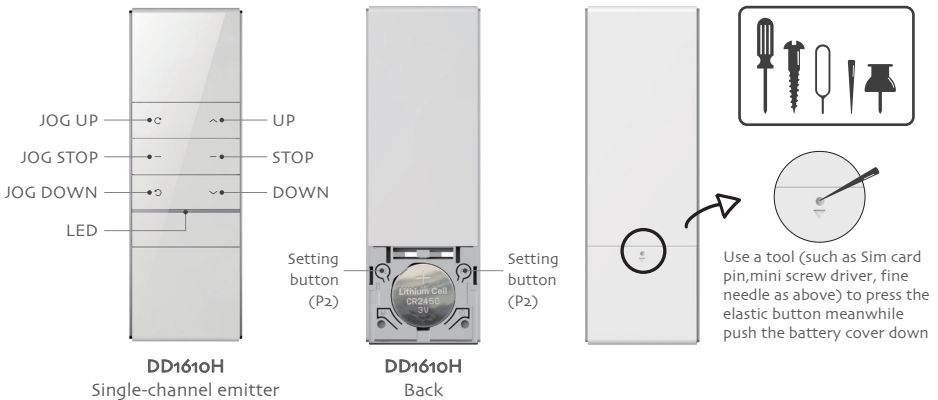

Technical specification

Battery: 3V (CR2450)	Battery life: >2 years	Radio frequency: 433.05~434.79MHz
Working temperature: -10℃~50℃	Transmitting power: 10 mW	Radio range: 200 meters outdoor, 35 meters indoor

Warning

- 1, Emitter couldn't expose to moisture or be struck heavily, or else the emitter life will be affected.
- 2, If the emitter is not so sensitive or the radio range becomes shorter, pls check whether to change the battery.
- 3, Under uni-directional mode, if you press any button more than 20s, while under bi-directional mode, you press any button 5s, the emitter will stop sending radio signals.
- 4, It's forbidden to use different type battery to avoid any dangerous risk.
- 5, Dispose of used batteries properly.

Uni-directional / Bi-directional Mode Switch

Note: The factory default mode is Bi-directional mode, repeat the same operation to switch the mode circularly.

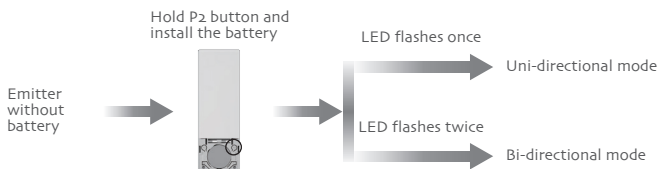

Combination Button Lock / Unlock Operation

Note: 1, Both the two P2 buttons on the back are operable.

2, If there is no operation for 10 seconds, it will automatically exit the setting status.

3, The factory default is unlock status, repeat same operation to switch status circularly.

4, When the combination buttons are locked, if you press the combination buttons, the emitter won't send any signal and LED won't flash.

5, Only the transmitting code will be affected if the combination buttons are locked.

Press and hold
STOP button
more than 15s



LED always on



P2 x 1



Flashes quickly
for 3S

→ Unlock status

Flashes slowly
for 3S

→ Lock status

