

Timer Check And Setting (Non Group Control)

- Note: 1,If the timer shows "--:--", means this channel no timer at the UP or DOWN direction.
- 2,During the setting status, every operation should be less then 60S, or else, it will exit the setting and back to original status.
- 3,Every channel can set the independent timer separately.
- 4,Under the timer setting status, short press CH+ button to switch to the setting content of the next timer setting, and short press CH- button to switch to the setting content of the previous timer setting.
- 5,Under the setting status, press STOP button to exit and setting without saving the setting.

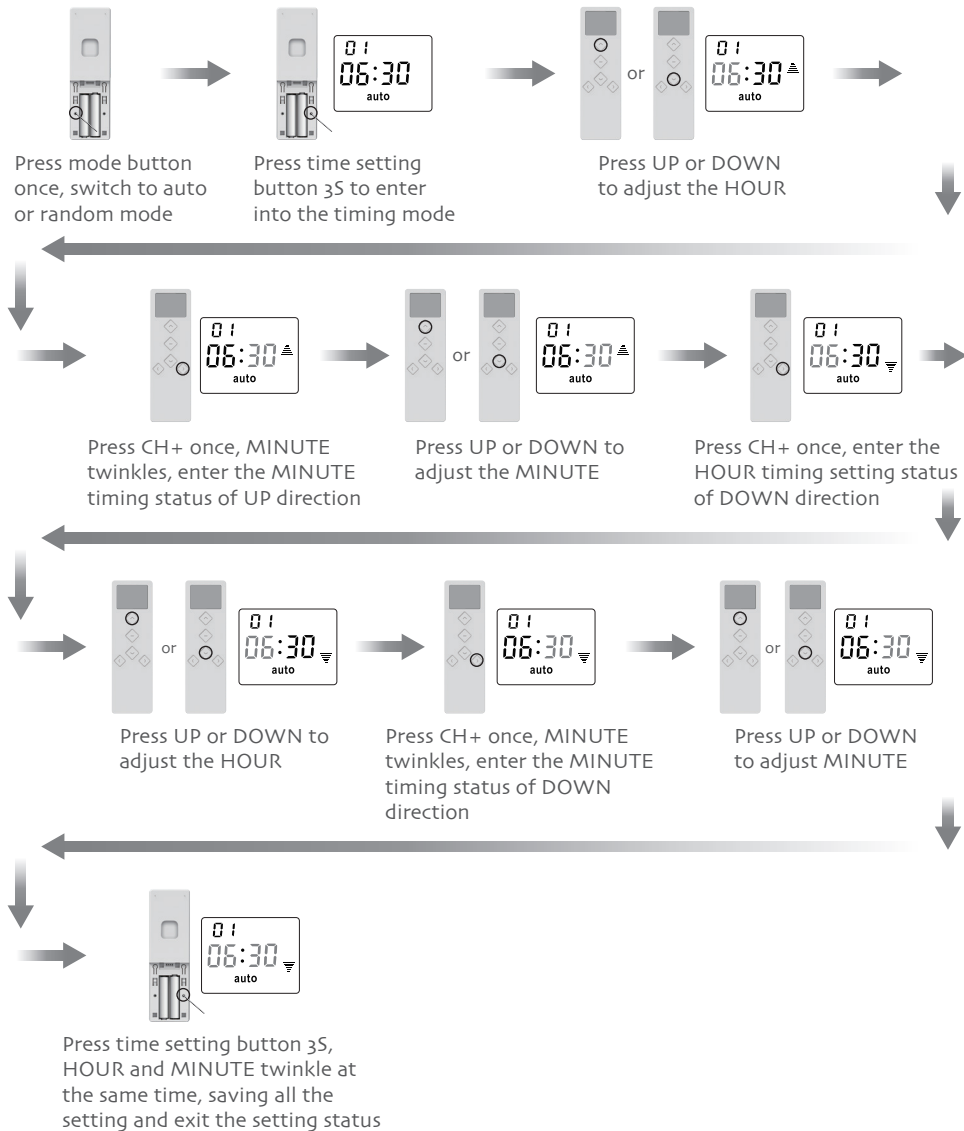

DD3003H DD3005H Timer Emitter Instruction

Version: A/00

Instruction Of Buttons

Note: This instruction takes DD3005H as an example. The operation of DD3003H is the same as DD3005H.

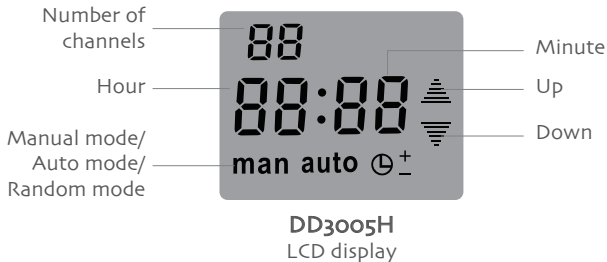
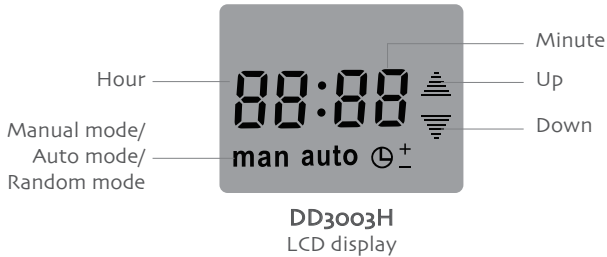
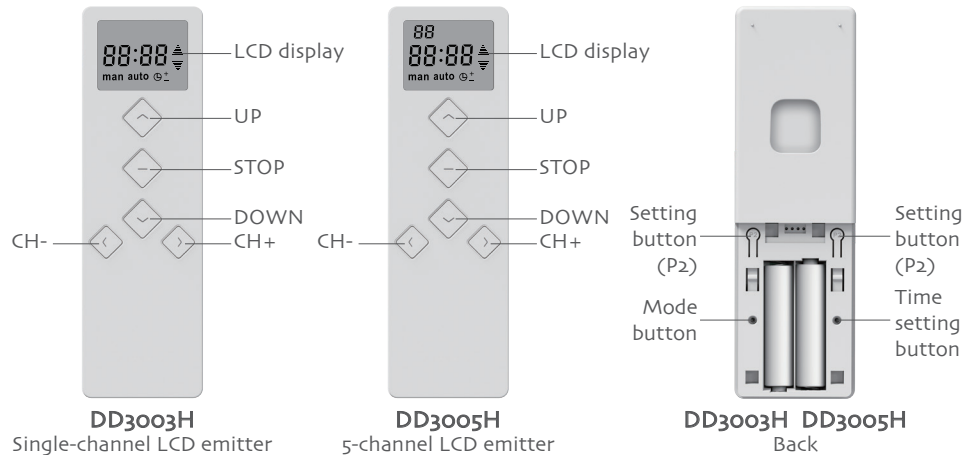

Technical specification

Battery: 3V (AAA battery × 2)	Battery life: >2 years
Radio frequency: 433.05~434.79MHz	Working temperature: -10℃~50℃
Transmitting power: 25 mW	Radio range: 200 meters outdoor, 35 meters indoor

Notices

- 1, Emitter couldn't expose to moisture or be striked heavily, or else the emitter life will be affected.
- 2, If the emitter is not so sensitive or the radio range becomes shorter, pls check whether to change the battery.
- 3, Under uni-directional mode, if you press any button more than 20S, while under bi-directional mode, you press any button 5S, the emitter will stop sending radio signals.
- 4, It's forbidden to use different type battery to avoid any dangerous risk.
- 5, Dispose of used batteries properly.

Switch Between Uni-directional And Bi-directional Mode

- Note: 1,Both setting buttons (P2) are operable.
2,The factory default mode is Bi-directional mode, repeat the same operation to switch the mode circularly.

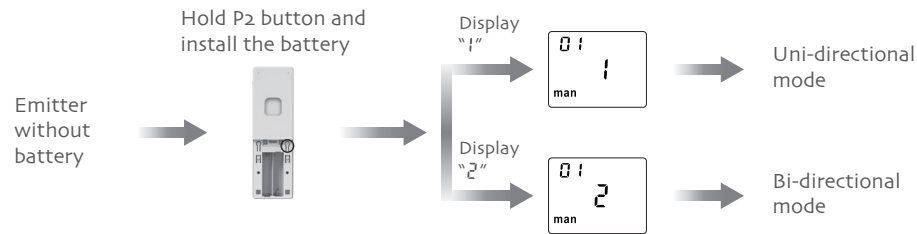

Lock / Unlock Combo-key Operation

- Note: 1,Both setting buttons (P2) are operable.
2,If there is no operation for 10 seconds, it will automatically exit the setting status.
3,The factory default is unlock status, repeat same operation to switch status circularly.
4,Under lock status, the combo-keys don't work; Under unlock status, the combo-keys will work normally.
5,Only the transmitting code will be affected if the Combo-keys are locked.

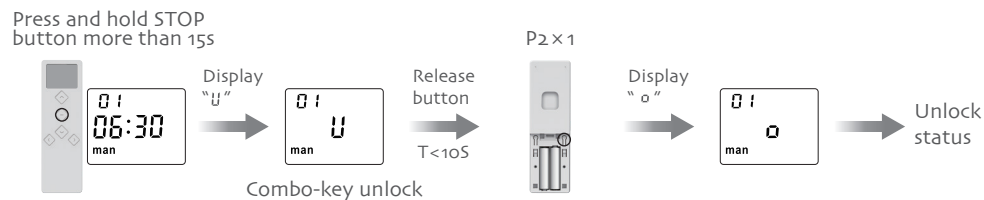
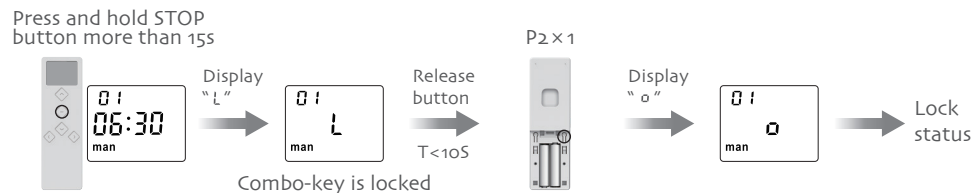

Mode Switch

Note: Manual Mode (man): only manual control; Auto Mode (auto): manual control and timer control; Random Mode (⊕ ⊖): manual control and random ±15mins control.

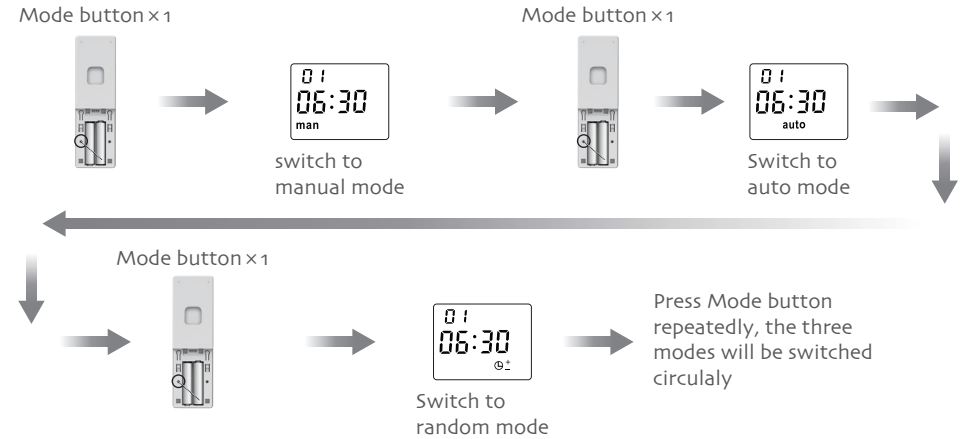

Current Time Setting (Only Manual Mode)

Note: 1,During the setting status, every operation should be less than 60s, or else, it will exit the setting and back to original status. 2,Press STOP button shortly, it will exit setting and save nothing. 3,The maximum error between current time and Beijing time is ±25 per day.

